

DATUM - 1.000 MT											
FINISHED ROAD LVL.	9.468	9.468	9.530	9.750	9.750	9.750	9.750	9.750	9.750	9.252	9.000
GROUND LVL. (mt.)	15.680	9.468	8.955	7.259	9.387	3.690	2.140	3.315	5.512	6.211	8.181
CHAINAGE (mt.)	14.400	10.000	8.450	5.000	0.000	5.000	8.930	10.000	10.000	17.475	21.900

SECTIONAL ELEVATION AT A-A
SCALE: 1:200 (SKEW DIMENSION IN BRACKET)

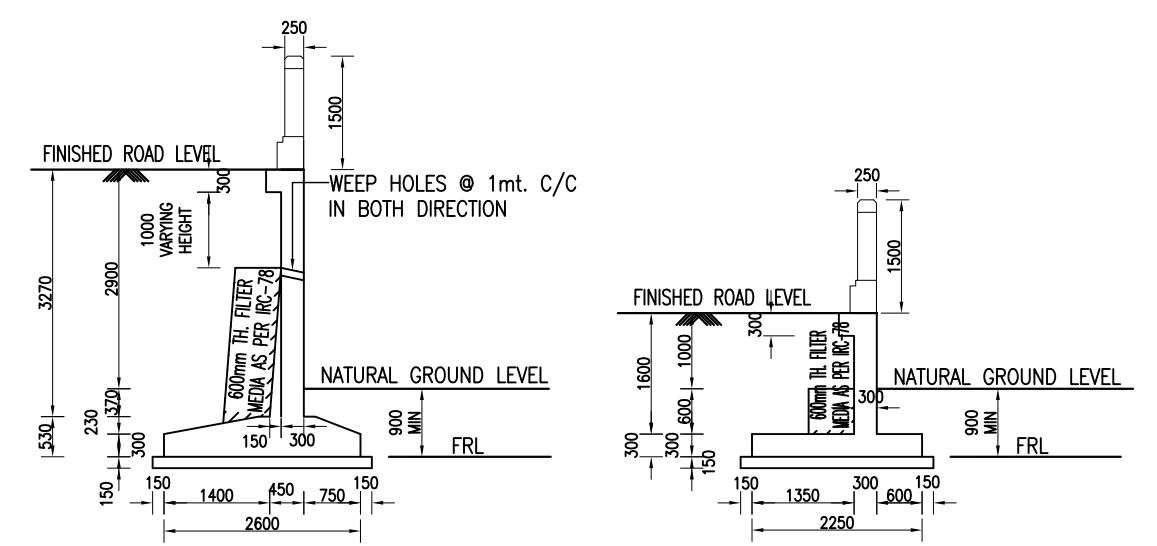

DIMENSIONAL DETAILS OF RCC RETAINING WALLS.

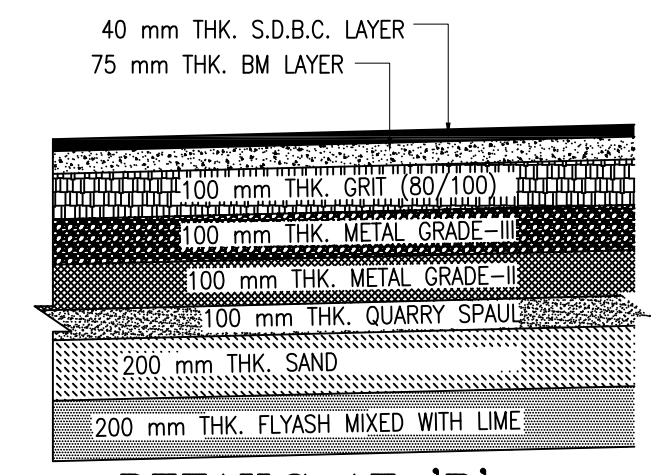

DETAILS AT 'R'
SCALE: 1:25

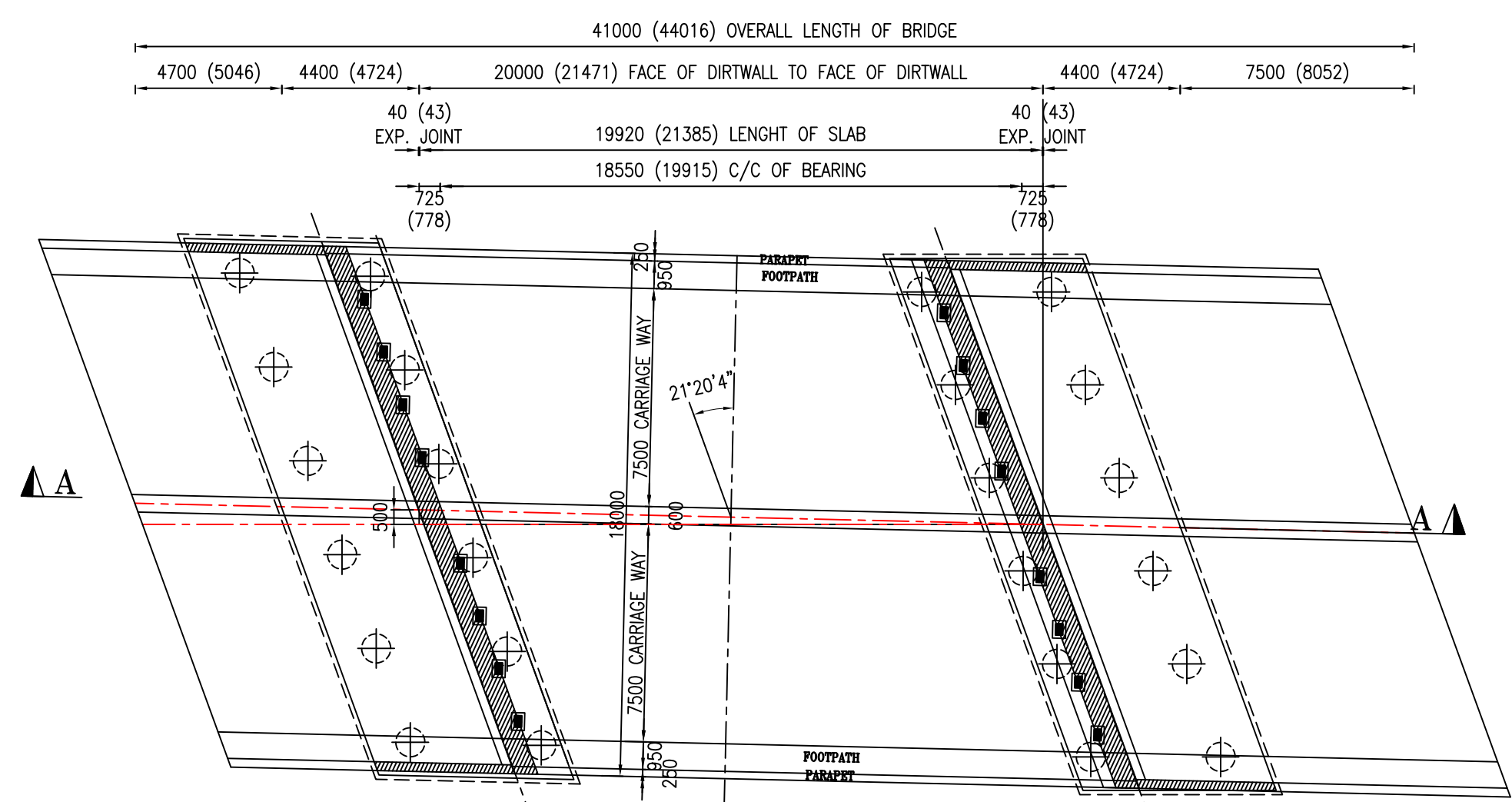

PLAN
SCALE: 1:200

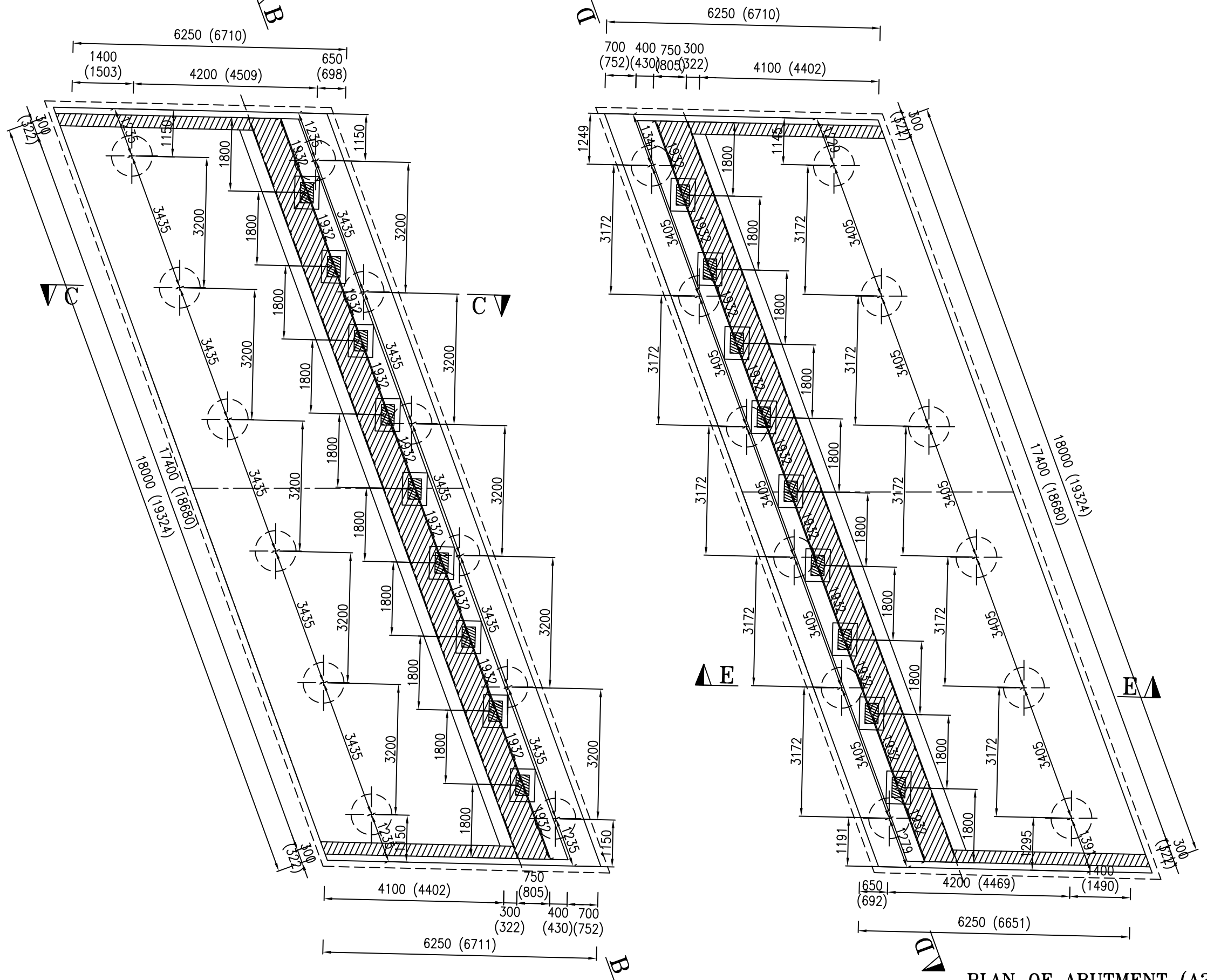

PLAN OF ABUTMENT (A1)
SCALE: 1:100

PLAN OF ABUTMENT (A2)
SCALE: 1:100

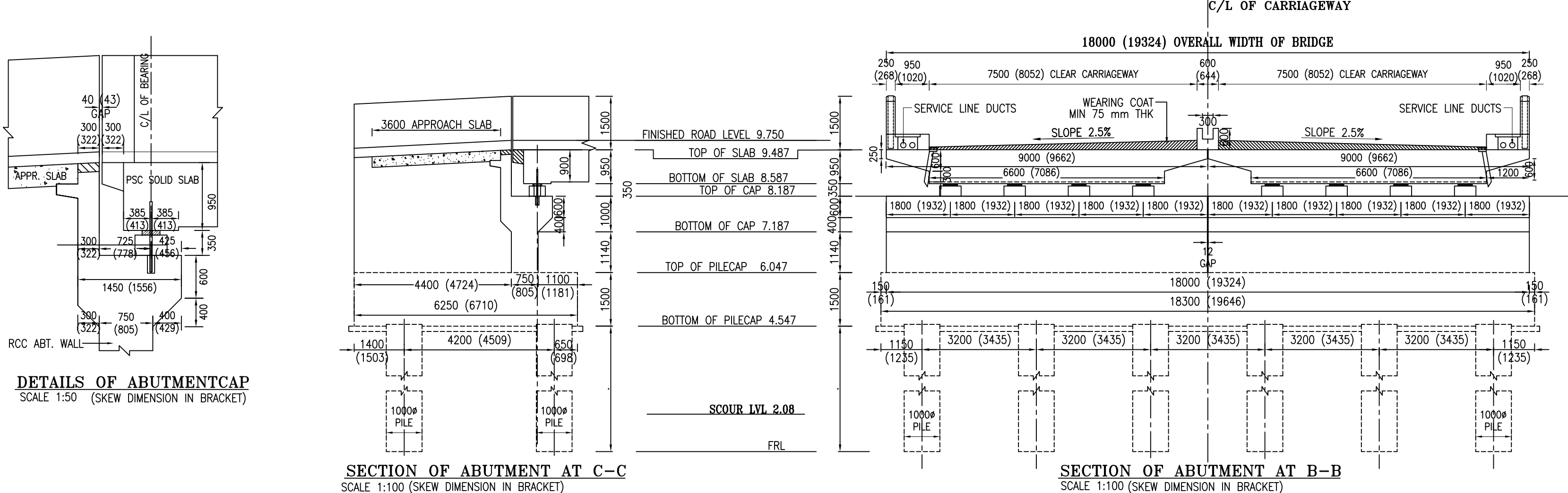

ABUTMENT A1

DETAILS OF ABUTMENT CAP
SCALE: 1:50 (SKEW DIMENSION IN BRACKET)

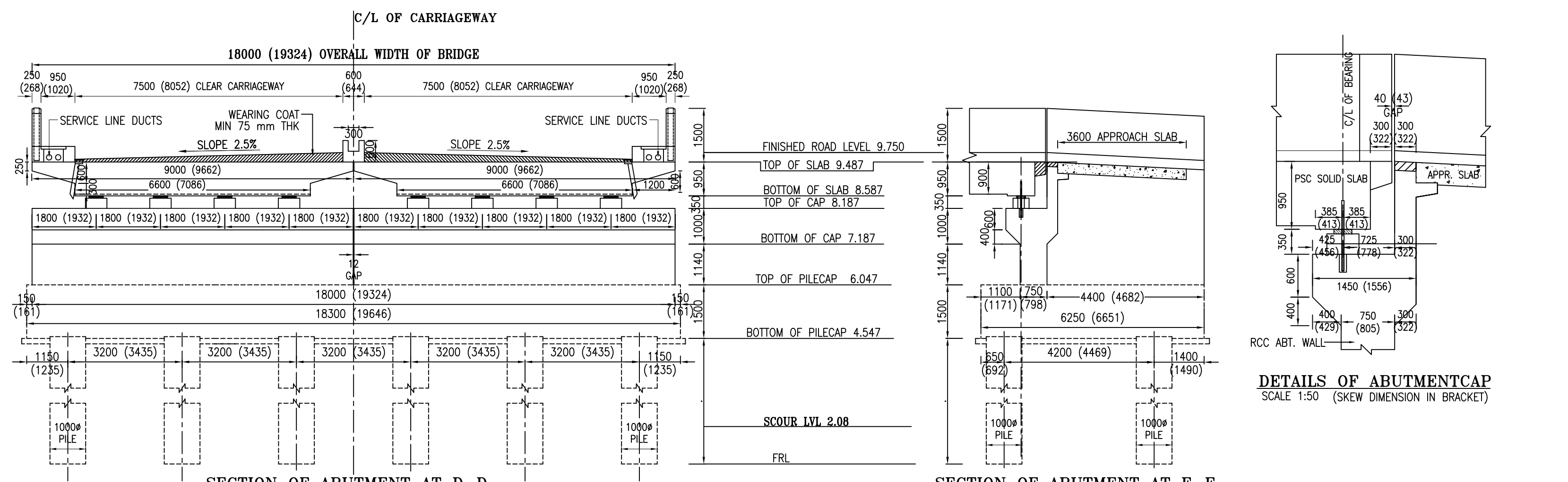

ABUTMENT A2

DETAILS OF ABUTMENT CAP
SCALE: 1:50 (SKEW DIMENSION IN BRACKET)

SECTION OF ABUTMENT AT D-D
SCALE: 1:100 (SKEW DIMENSION IN BRACKET)

SECTION OF ABUTMENT AT E-E
SCALE: 1:100 (SKEW DIMENSION IN BRACKET)

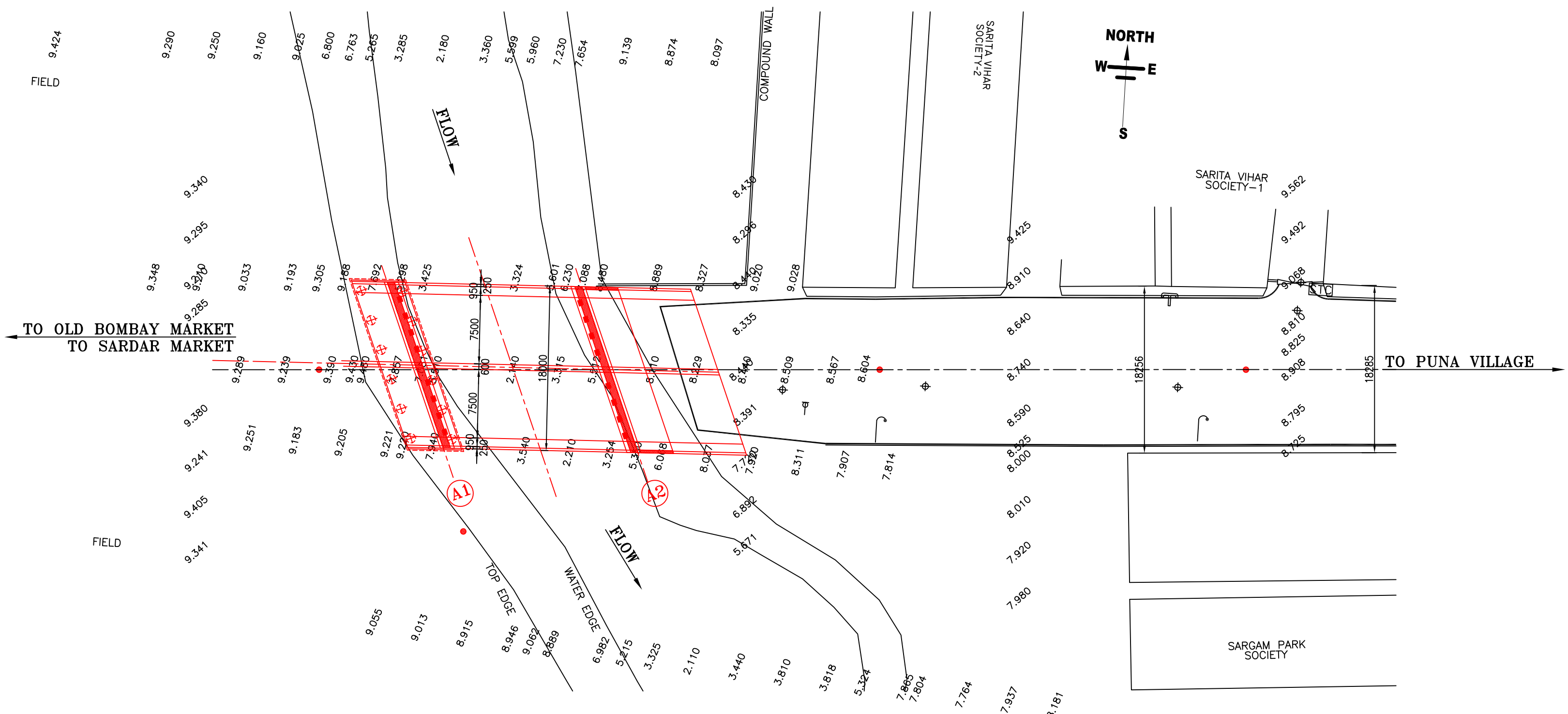

KEY PLAN
SCALE: NTS

NOTES :-

- ALL DIMENSIONS ARE IN MM AND LEVELS ARE IN MTRS UNLESS SPECIFIED OTHERWISE.
- DIMENSIONS ARE NOT TO BE SCALED. ONLY WRITTEN DIMENSIONS ARE TO BE FOLLOWED.
- THIS DRAWING IS PREPARED FROM DETAILED SURVEY AND IN CO-ORDINATION WITH SMC'S OFFICIALS.
- DURING EXECUTION OF NEW BRIDGE IT IS CONTRACTOR'S RESPONSIBILITY THAT THERE WILL NOT BE ANY DAMAGE TO ANY COMPONENT OF EXISTING STRUCTURE.
- EARTH FILLING IS TO BE PROVIDED AT ABUTMENT OF NEW PROPOSED BRIDGE WITH PROPER COMPACTION.
- PROPOSED WORK SHOWN IN RED IN KEYPLAN.
- THE DIMENSIONS SHOWN ARE TENTATIVE AND SHALL BE AS PER FINAL DESIGN.
- THE ARRANGEMENT, TYPE OF SUPERSTRUCTURE, DIAMETER/THICKNESS, DEPTH & THICKNESS OF SUB-STRUCTURE MEMBERS, ETC. ARE TENTATIVE AND SHALL BE AS PER FINAL DESIGN.
- DRAINAGE SPOUT, EXPANSION JOINT & WEARING COAT SHOULD BE AS PER SPECIFICATIONS AND DETAILED DRAWINGS.
- THE CONSTRUCTING AGENCY SHOULD ENSURE THAT THE NECESSARY PERMISSION HAS BEEN OBTAINED FROM MUNICIPAL CORPORATION FOR DIVERTING THE TRAFFIC TEMPORARILY PRIOR TO COMMENCING THE WORK.
- UNDER GROUND CABLE ETC. IF ANY SHALL BE REMOVED & RE-ALIGNED BEFORE THE EXECUTION OF WORK STARTS.
- NECESSARY SUITABLE SHORING AND STRUTTING SHALL BE PROVIDED FOR CASTING OF STRUCTURAL MEMBERS AND AT OTHER PLACE WHERE EVER REQUIRED AND DETAILED DRAWING SHALL BE SUBMITTED BY THE CONTRACTOR.
- BRIDGE HAS BEEN DESIGNED FOR ONE LANE OF CLASS 70(R) OR TWO LANES OF CLASS 'A' ALONGWITH FOOTPATH LOADING, WITH WORST COMBINATION. FOOTPATH LOADING SHALL BE AS PER CLAUSE 209.1 OF IRC-8-2000
- MIN. GRADES OF CONCRETE FOR VARIOUS COMPONENTS OF BRIDGE SHALL BE AS BELOW. IT WILL BE AS PER TENDER SPECIFICATION AND DETAILED DRAWING

o) LEVELLING COURSE	M-15
b) PILES & PILE CAP	M-35
c) FOUNDATION CONCRETE	M-35
d) SUBSTRUCTURE CONCRETE	M-35
e) CAPS, PEDESTALS, DIRTWALL	M-35
f) SUPERSTRUCTURE (PSC SOLID SLAB)	M-40
g) WEARING COAT	M-30
h) CRASH BARRIER & KERBSTONE	M-35
i) FOOTPATH SLAB & APPR. SLAB	M-25
j) RAILING & PARAPET	M-25

R2	10-01-13	FINISHED ROAD LEVEL MODIFIED TO 9.750.(TO SUIT END OF BRIDGE)
R1	30-11-12	SKEW ANGLE MODIFIED DUE TO CHANGE IN ROAD CENTER LINE

REV. NO.	DATE	DESCRIPTION
----------	------	-------------

EXECUTIVE ENGINEER
SURAT MUNI. CORP.
SURAT

CONSULTANTS

PROJECT :
CONSTRUCTION OF BRIDGE ACROSS CREEK IN T.P.NO.34, MAGOB ON 18.00 MT WIDE ROAD NEAR BHAGYODAY INDUSTRI IN VARACHHA AREA, SURAT.

CLIENTS :
THE MUNICIPAL COMMISSIONER,
SURAT MUNICIPAL CORPORATION, MUGLISARA,
SURAT - 390005

CONSULTANTS :
PANKAJ PATEL & ASSOCIATES
303, CHAKRAVARTY COMPLEX, OPP. KIRAN PARK CIRCLE,
NAVA VADAJ, AHMEDABAD-380013
PH/FAX : 079-27643175, 27640428
E-mail : paa_99@yahoo.co.in, paa99@gmail.com

TITLE :
GENERAL ARRANGEMENT DRAWING

DRAWN BY : NILESH	DRG. NO. BHAGYODAY 02	REVISION R2
CHECKED BY : PANKAJ PATEL		
DATE : 25-02-2012		